



Paloma

HOT CONTINUOUS WATER ON DEMAND

FOR OVER 100 YEARS

FREE UP
VALUABLE
SPACE

REDUCE
RUNNING
COSTS

SAY GOODBYE
TO COLD
SHOWERS

NO NEED FOR
A STORAGE
CYLINDER

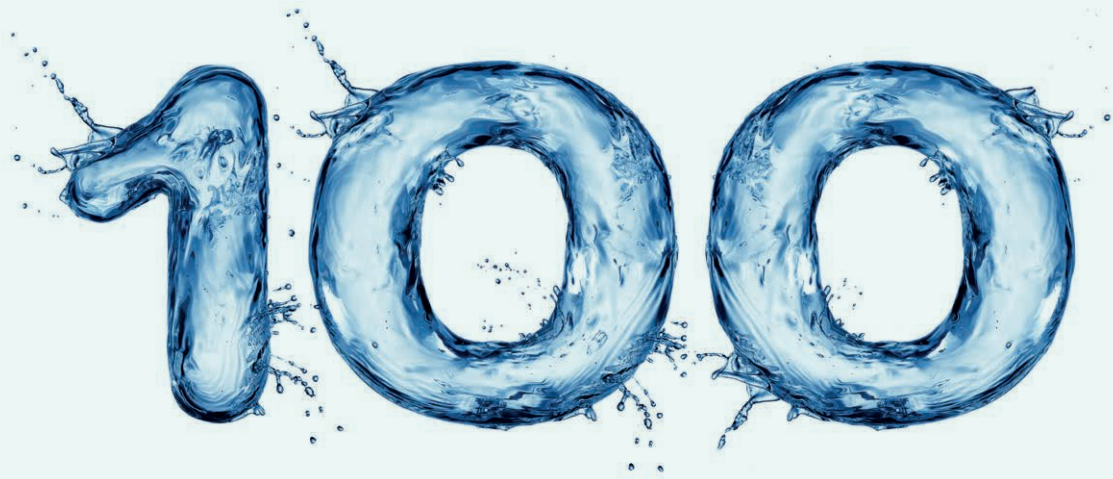

YEARS IN THE GAS APPLIANCE INDUSTRY

Paloma began life in 1911 as a privately owned manufacturing company that was a pioneer in the Japanese gas appliance industry. Today, Paloma is a world leading producer of gas appliances. Paloma's products, for both a commercial and residential applications are found around the world and operate in a broad variety of installations.

Paloma prides itself on its commitment to achieving the highest level of safety engineering of any company in the gas appliance industry. Paloma products are certified to the safety standards of the countries where Paloma does business.

Paloma Group is headquartered in Nagoya, Japan and has manufacturing facilities and sales offices in many countries around the world.

Since 2001, Paloma has been proudly distributed in New Zealand by Hamilton based family firm, Aber Living.

With over 30 years experience in distributing home heating and energy-related products we have a well established network of trained installers and service agents to ensure safe, reliable and quality service to our customers.

WHY CHOOSE PALOMA CONTINUOUS FLOW WATER HEATING?



PERFECT FOR TODAY'S BUSY LIFESTYLES

With continuous flow hot water, you can enjoy hot water on demand with precise temperature control and an endless supply of hot water.

ENVIRONMENTALLY RESPONSIBLE

Gas burns the cleanest of all fossil fuels, resulting in less greenhouse gas emissions. Gas is also a highly efficient direct fuel, so is not only a great option for your home, but also for the environment.

ADDS VALUE

Gas appliances can increase the appeal and value of your home. Gas water and home heating are highly desired both for the lifestyle and cost savings they can offer.

COST SAVINGS

Paloma water heaters operate on Natural Gas or LPG, reducing the electricity demands on your household.

With all things being equal, gas is and will continue to be cheaper than electricity, especially as gas is used in the production of electricity.

So say goodbye to cold showers and increasingly high electricity bills. Paloma ensures that you have hot, continuous water as you need it, EVERY TIME. And because you only heat the water you need, it means you won't blow your budget.



...because you only heat the water you need, it means you won't blow your budget.

COST OF HEATING ENOUGH WATER FOR A 10 MINUTE SHOWER

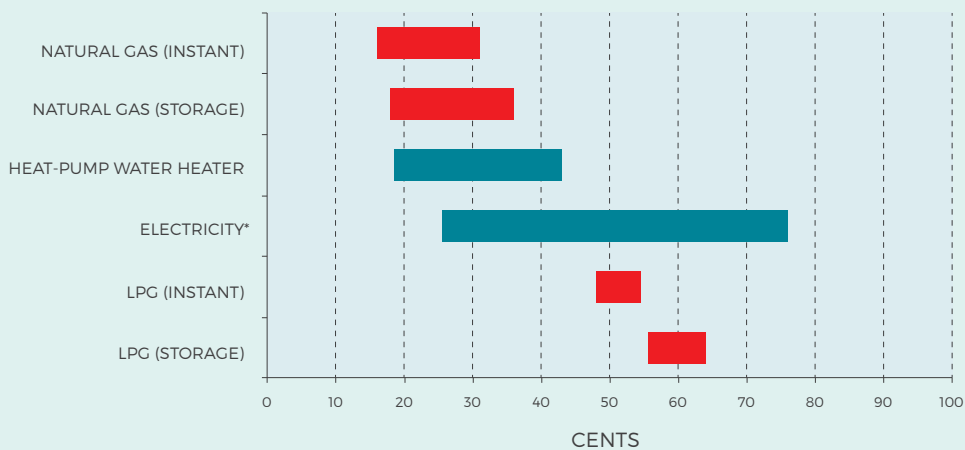

* Standard hot water cylinder

Semi Renewable Non Renewable

DATA SOURCE: consumer.org.nz, May 2017



KEY FEATURES

PRODUCT SELECTION

Choosing the right gas water heater is not only an investment in your home, but in today's fast paced world, it's important to know that you have enough hot water at any time, to do the washing, have multiple showers or enjoy a long soak in the bath.

With a Paloma water heater you can heat as much water as you require, so your key consideration when selecting the right model is the number of hot water outlets you may use at one time to maintain maximum water flow. Modern bathroom designs, with an extensive array of shower heads on offer, mean it is important to consider the water draw required to enjoy the full blast from your fittings. An

average shower head uses 8-12L/min, while designer shower heads may use up to 25L/min.

Paloma 16, 24 and 27 Litre water heaters suit both residential and light commercial applications. For larger installations multiple units can be manifolded together to satisfy more demanding requirements such as larger households, sports clubs and light commercial applications where multiple outlets are often used at the same time.

We recommend consultation with a specialist plumber / gasfitter who will provide you with the best size Paloma water heater for your requirements.

Paloma 16

= 16L of hot water per minute



Paloma 24

= 24L of hot water per minute

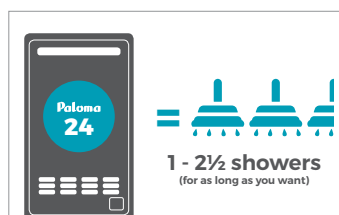

Paloma 27

= 27L of hot water per minute



PRODUCT RANGE

EXTERNAL UNITS WITH MINIMAL IMPACT

Discreetly located on an outside wall, ideally located near the most used water outlet, eg. kitchen. The external water heaters take up minimal space and are unobtrusive ensuring minimal impact on your home and surroundings.

Q Function
Solar Boost (Optional)
Hot Water Circulating System Compatible
Flame Failure Device

Flamesafe® Over-Heat Protection System
Oxygen Depletion Sensor
Water Pressure Relief Valves
Overheat Limit Switch

Anti-frost Protection
Error Code Recall
LPG or NG Models Available



PH2760F

27

- 27 Litre Output
- EZ Link Ready



PH2405AW

24

- 24 Litre Output
- EZ Link Ready



PH1605AW

16

- 16 Litre Output
- EZ Link Ready

REMOTE CONTROLLERS

The Paloma range comes with optional Remote Controllers which allows you to precisely control the water temperature in the bathroom, kitchen and laundry, giving you the luxury of enjoying the perfect temperature every time. (Pre-set temperatures are available without controllers.)

The Standard Controller beeps when the bath has reached the desired level.

The Deluxe Controller offers the additional benefits of a voice prompt feature and a bath-fill function stops the water flow, providing safety and peace of mind.



STANDARD

MC-101N



DELUXE

MC-115VN



FEATURES

Paloma's high quality standards ensure all water heaters are specified with the following safety and innovative technology features:



EFFICIENCY

With a Paloma water heater you are not storing water to keep it hot, you only pay for the energy you use when it is operating, making it more efficient than a storage water heater.

Paloma water heaters proudly achieve the highest energy star rating - 6 star.

Each extra star featured on the energy rating label found on the front of the unit, means an additional 10% or more savings on running costs. The more efficient the water heater is, the more heat it delivers per unit of energy used.



SPACE MANAGEMENT

Whether it is a retro-fit or new home you will gain valuable indoor space with compact and unobtrusive Paloma Units. Optional pipe covers and recess kits are available to conceal pipe-work and heaters and ensure a streamlined look for the home.



CONTROL

Programmable digital remote controllers allow the water temperature to be precisely controlled to the level required. This reduces your energy costs as hot water is not mixed with cold to lower its temperature. This is the ultimate in convenience, efficiency and safety - you can enjoy the perfect temperature every time and have peace of mind when children are using hot water in the bathroom. Choose from Standard or Deluxe controllers depending on your requirements.



QUALITY (Q) FUNCTION

Provides superior temperature control with minimal water temperature fluctuation.



SOLAR BOOST

The optional solar boost function enables the water to be used as a hot water boost in conjunction with most solar heating systems. The heater is connected in series with the storage cylinder, boosting the water temperature during low solar gain, delivering an uninterrupted hot water supply.



HOT WATER CIRCULATING SYSTEM

A Paloma water heater can be installed as part of a circulated hot water flow and return system. This enables a continual source of hot water without delay.



ANTI-FROST

The frost protection system protects the water heater from damage, by preventing ice forming in the waterways of the water heater in the event of freezing conditions occurring (above -20°C, including wind chill factor).



SAFETY

The state-of-the art Flamesafe® over-heat protection system automatically shuts down the water heater should a fault occur.

Other built-in safety features include a Flame Failure Device, Overheat Limit Switch, Water Pressure Relief Valves and Error Code Recall which all provide reassurance that the water heater will operate safely at all times.



MANIFOLDING & CUSTOM SOLUTIONS

For larger installations multiple units can be manifolded together to supply hot water through a single pipe system to satisfy more demanding requirements such as larger households, sports clubs and light commercial applications where multiple outlets are often used at the same time.

All models are compatible with the easy-to-install EZ-Link® System which is used to electronically control two identical water heaters. Plumbed in parallel, from the same temperature controller, they operate as one combined unit, enabling the two units to supply through one pipe system. Depending on demand, one or both units may be in operation.

All models can also be manifolded using PAM (Pressure Actuated Manifold) valves where multiple units can be joined together.

This type of manifolding operates in a step-down system, whereby the greater the draw of water, the more units that will activate.



WARRANTY



You can purchase a Paloma water heater with confidence, knowing that it has been manufactured to the highest standards, and complies fully with New Zealand regulations. The water heaters have a comprehensive **10 year** pro-rata warranty on the heat exchanger and a **3 year** parts and labour warranty when installed in a residential dwelling. Terms and conditions apply.

ACCESSORIES

CLEAN EXTERIOR DESIGN

Pipe Cover or Recess Kits provide discreet installation, concealing the pipe-work and heater to maintain clean design lines on your property.

PIPE COVER



16L

PC16-20A

24L

L28A

27L

PC27

RECESS KIT



24L

RK-24-P

27L

RK-27-P



TECHNICAL INFORMATION

	16	24	27
Model No	PH1605AW	PH2405AW	PH276OF
Location	External	External	External
Recommended No. Water Outlets Operating at One Time*	1	2	3
Hot Water Capacity @ 25°C Rise	16 Litre	24 Litre	27 Litre
Dimensions (mm):			
Height	520	520	601
Width	355	355	351
Depth	187	187	226
Weight (empty)	16kg	16kg	23kg
Output	27.9kW	40.0kW	47.8kW
Input	126MJ/HR	188MJ/HR	205MJ/HR
Connections (Hot/Cold/Gas)	3/4" / 20mm	3/4" / 20mm	3/4" / 20mm
Inlet Operating Water Pressure:			
Minimum	120kPa	120kPa	140kPa
Maximum	1000kPa	1000kPa	1000kPa
Normal Power Consumption	40W	54W	80W
Anti-Frost Power Consumption	106W	127W	175W
Temperature Settings without Controller	43°C, 55°C, 75°C	40°C, 43°C, 50°C, 55°C, 60°C, 75°C	38°C, 40°C, 42°C, 43°C, 45°C, 50°C, 55°C, 70°C, 75°C
EZ Link	✓	-	✓
Solar Boost (Optional)	✓	✓	✓
Hot Water Circulating System Compatible	-	✓	✓
Safety Features:			
Over Heat Limit Switch	✓	✓	✓
Anti-Frost Protection	✓	✓	✓
Water Pressure Relief Valve	✓	✓	✓
Flamesafe®	✓	✓	✓
Flame Failure Device	✓	✓	✓
Digital Diagnostic Display	✓	✓	✓
Q Function	✓	✓	✓
Recess Kit (mm) (HxWxD) <small>(wall hole dimensions)</small>	-	1045 x 415 x 230 RK-24-P	1040 x 415 x 185 RK-27-P
Pipe Cover (mm) (HxWxD)	400 x 350 x 135 PC16-20A	400 x 350 x 195 L28A	420 x 350 x 200 PC27
Paloma Flue Kit	-	-	-
Clearance to Combustibles (mm) as per NZ5601:			
Above	300	300	500
Sides	300	300	500
Back	10	10	10
Front	500	500	500
Recommended Height from Ground to Flue Outlet	1800mm	1800mm	1800mm

* Additional outlets may be used but flow may be reduced

WARRANTY

RESIDENTIAL

Pro-rata 10 years – Heat exchanger (parts only) from date of installation, eg. within 2nd year 80%, 4th year 60% of the value of the part
3 years – All other parts and labour

COMMERCIAL

1500 hours or 1 year – (which ever comes first)
All parts and labour from date of installation.

For full terms and conditions visit:
www.palomanz.co.nz

TECHNICAL DRAWINGS

External Models

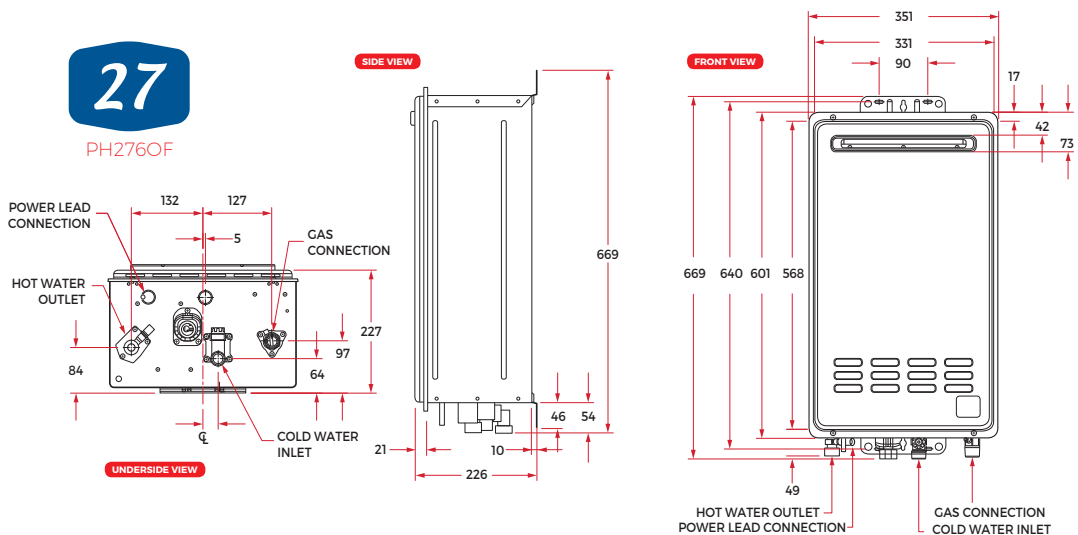
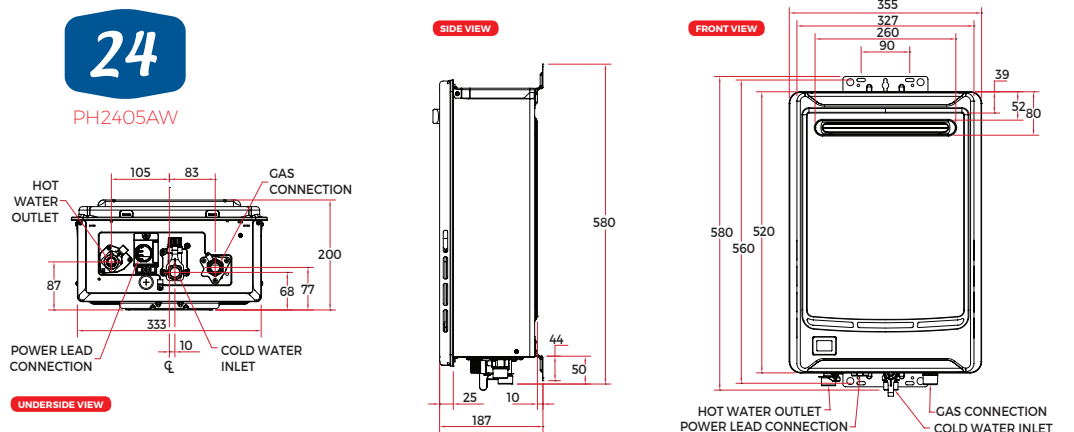
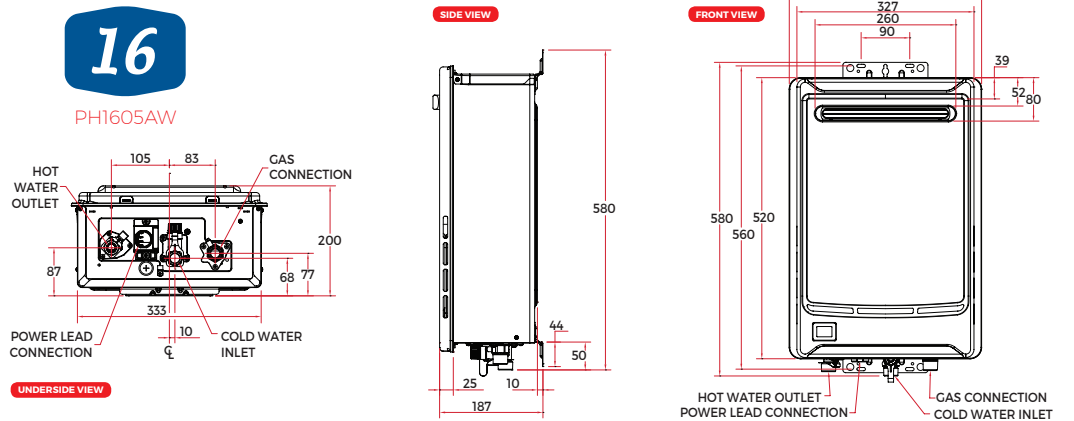

Controllers

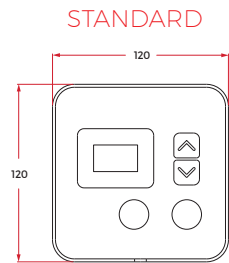

FRONT VIEW

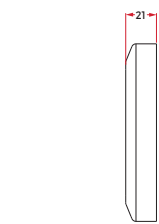

SIDE VIEW

KITCHEN - MC-101N
BATHROOM - SC-101N
BATHROOM 2 - SC-101SN

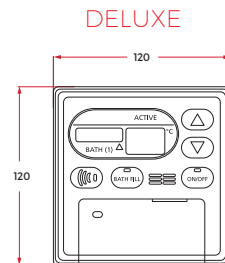

FRONT VIEW



SIDE VIEW

KITCHEN - MC-115VN
BATHROOM - SC-115VN
BATHROOM 2 - SC-115VSN





Paloma

HOT CONTINUOUS WATER ON DEMAND

Product specifications are at date of publication and are subject to change without notice.



Paloma products are distributed by:
Aber Holdings Ltd T/A Aber Living
17 Mainstreet Place, Te Rapa
Hamilton 3200
Free Phone: 0800 161 161
Free Fax: 0800 163 163
www.aberliving.co.nz

www.palomanz.co.nz

MM327-05/18